

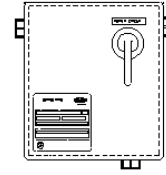

Cooling Tower Accessories



Basin Heater Control Panels

Basin Heater Control Panels are a NEMA 4 rated weatherproof enclosure. The enclosures house the Low Water Cutoff and Thermostat.

If the heater is operating when it is not completely covered with water, irreparable damage may result. The *Low Water Cutoff* prevents such damage. It consists of two components: A 316 Stainless Steel Probe, installed at least 2" above the element heating; and a relay to deenergize the heater when the water level drops below the probe. A weatherproof cord connects the probe and relay.

The thermostat will energize the heater as the water temperature reaches the freezing point. The thermostat is a bulb and capillary device with a 35° to 110°F range and a fixed 3°F differential. Each thermostat is furnished with a stainless steel well to house and permanently locate the bulb. The well is installed through a Scru-Tite hub, also furnished, which should be at the same level as the heater.

Basin Heater Control Panels

Standard Control Panel Includes		Part Number
<ul style="list-style-type: none"> > 0 to 100 F thermostat Calibrated for freeze protection >Low water cutoff floatless type with low voltage probe >3 Pole contactor rated 40 amps 	Standard Panel	HCP-100
	Standard Panel / w Door Disconnect	HCP-101
	Standard Panel / w Fusing	HCP-102
	Standard Panel / w Circuit Breaker	HCP-103
	Standard Panel / w Fusing & Door Disconnect	HCP-104
	Standard Panel / w Circuit Breaker and Door Disconnect	HCP-105



Cooling Tower Accessories

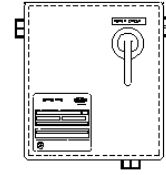

Basin Heater Control Panels

- NOTES:
 1) PANELS ARE UL & CSA LISTED TYPE 4 ENCLOSURES.
 2) TEMPERATURE RANGE FROM -104° TO 266°F
 3) ENCLOSURE MADE OUT OF A MOLDED FIBERGLASS POLYESTER.
 4) DISCONNECT SWITCH HANDLE IS LOCKABLE IN THE OFF POSITION.

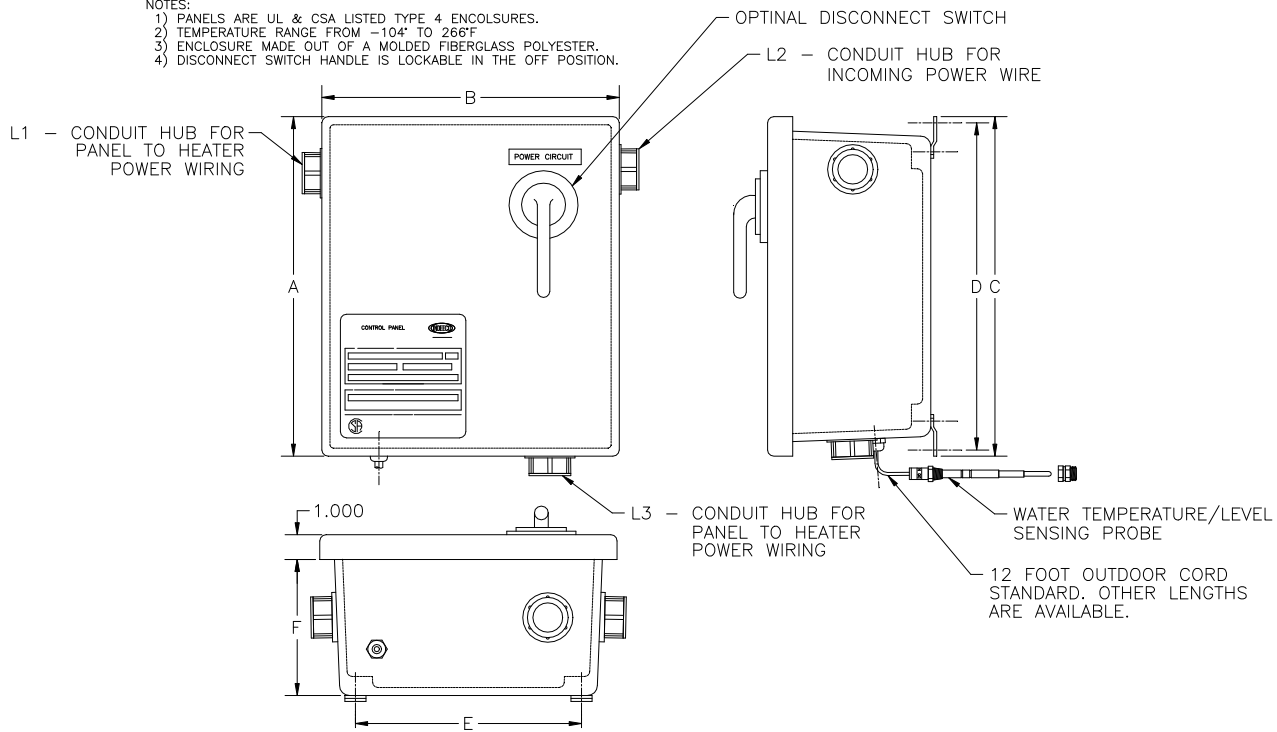

Part Number	Panel Dimensions (inches)						Hub Locations / Size		
	A	B	C	D	E	F	L1	L2	L3
HCP-100	13.73	11.85	13.73	13.23	5.5	9.01		1" NPT	1-1/4" NPT
HCP-102	15.73	13.85	15.73	15.23	5.5	11.01	1-1/2 NPT	1" NPT	
HCP-103									
HCP-104									
HCP-105									
HCP-106									